

A filopiano lavabo integrato / integrated plan washbasin / vasque en plan intégrée / integrierte Waschtischplatte

FINITURE: CERAMICA 1,5 cm bianco opaco/lucido & 4 colori opaco CASTMARBLE 1,2 cm bianco opaco/lucido & 48 colori.02 PROFONDITÀ: 46,5-51,5 cm	FINISHES: CERAMIC 1,5 cm matt/glossy white & 4 matt colors CASTMARBLE 1,2 cm matt/glossy white & 48 colori.02 DEPTH: 46,5-51,5 cm	FINITIONS: CÉRAMIQUE 1,5 cm blanc mat/brillant & 4 couleurs mat CASTMARBLE 1,2 cm blanc mat/brillant & 48 colori.02 PROFONDEUR: 46,5-51,5 cm	OBERFLÄCHEN: KERAMIK weiß matt/glänzend & 4 matt Farbe CASTMARBLE weiß matt/glänzend & 48 colori.02 TIEFE: 46,5-51,5 cm
--	---	--	---

B contenitore / interior configuration / configuration intérieure / Innenausstattung

realizzato in pannelli di particelle di legno di spessore 18 mm, idrofughi, nobilitato con carta melaminica colore URBAN. Bordi in ABS in tinta. Cassetto montato su guide GRASS® ad estrazione totale con sponde laterali in metallo verniciato colore URBAN. Fondo e schienale nella finitura del contenitore ALTEZZA: 50 cm PROFONDITÀ: 46,5-51,5 cm LARGHEZZA: 60-70-80-90-105-120-140 cm	made of water repellent panels of 18 mm thick wood particles, covered with Nobilitato URBAN color. Matching ABS edges Drawer mounted on full extension GRASS® runners with URBAN color painted metal sides. Bottom and back in the finish of the container HEIGHT: 50 cm DEPTH: 46,5-51,5 cm WIDTH: 60-70-80-90-105-120-140 cm	en panneaux hydrofuges en particules de bois de 18 mm d'épaisseur. Recouvert de papier mélaminé couleur URBAN. Bords ABS de la même couleur Tiroir monté sur coulisses GRASS® pleine extension avec côtés en métal peint couleur URBAN. Fond et retour dans la finition du interieur HAUTEUR: 50 cm PROFONDEUR: 46,5-51,5 cm LARGEUR: 60-70-80-90-105-120-140 cm	in wasserabweisenden Platten aus 18 mm starken Holzpartikeln. Farbmelaminpapier und ABS Kanten der gleichen Farbe Schublade montiert auf GRASS® Vollauszügen mit URBAN-farbig lackierten Metallseiten. Boden und Rückseite im Abgang des Behälters HÖHE: 50 cm TIEFE: 46,5-51,5 cm BREITE: 60-70-80-90-105-120-140 cm
---	--	--	---

C frontale / front panel / tiroir / Schublade

realizzato in pannelli di particelle di legno idrofugo nobilitato con carta melaminica SPESSORE: 1,8 cm FINITURE: Laccato OPACO/LUCIDO 48 colori.02 - Nobilitato LEGNO	made of water repellent panels of wood particles THICKNESS: 1,8 cm FINISHES: MATT/GLOSSY Lacquered 48 colori.02 - Nobilitato LEGNO	en panneaux hydrofuges en particules de bois recouvert de papier mélaminé ÉPAISSEUR: 1,8 cm FINITIONS: Laqué MAT/BRILLANT en 48 colori.02 - Nobilitato LEGNO	aus wasserabweisenden Spanplatten, veredelt mit Melaminpapier DICKE: 1,8 cm OBERFLÄCHEN: MATT/HOCHGLANZ Lack aus 48 colori.02 - Nobilitato LEGNO
--	--	--	--

D apertura / opening system / système d'ouverture / Öffnungssystem

Maniglia FILO / Maniglia PONTE / Smusso 45° / Sistema Premi-Aprì	FILO Handle / PONTE Handle / Smusso 45° / Premi-Aprì System	Poignée FILO / Poignée PONTE / Smusso 45° / Système Premi-Aprì	FILO Griff / PONTE Griff / Smusso 45° / Premi-Aprì System
--	---	--	---

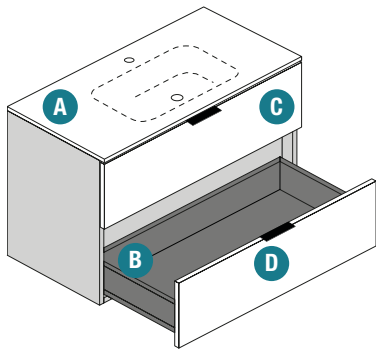

Maniglia FILO
FILO Handle
Poignée FILO
FILO Griff

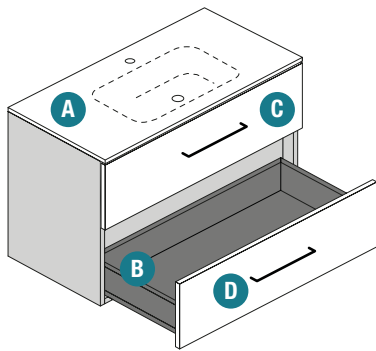

Maniglia PONTE
PONTE Handle
Poignée PONTE
PONTE Griff

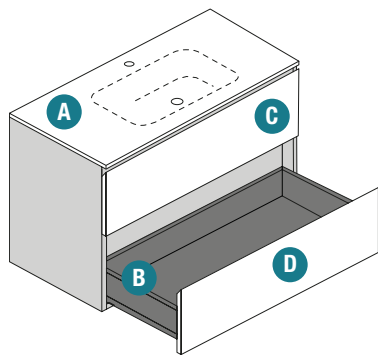

Smusso 45°

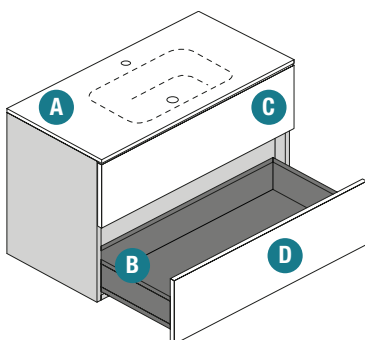

Sistema Premi-Apri
Premi-Apri System
Système Premi-Apri
Premi-Apri System



Nobilitato LEGNO

pannello di particelle di legno spessore 18 mm idrofugo a basso contenuto di formaldeide nobilitato interno ed esterno con carta melaminica in finitura LEGNO riprodotto ad alta fedeltà; bordo in ABS in finitura

high pressure layered laminate, a perfect and strong imitation of the natural wooden surface

stratifiés décoratifs haute pression. Plaques à base de résines thermoscurissables appelées stratifiés

Hochdruckmehrschichtlaminat mit einer dreidimensionalen Erscheinung

**laccato OPACO / LUCIDO
MATT / GLOSSY lacquered**

pannello di particelle di legno, idrofugo, a basso contenuto di formaldeide, verniciato con resine poliuretaniche pigmentate opache o lucide

wood particles panel 18 mm with low formaldehyde content, painted with polyurethane resins

**laqué MAT / BRILLANT
MATT / HOCHGLANZ lackiert**

panneaux de particules de bois 18 mm à faible teneur en formaldéhyde, peint avec des résines de polyuréthane

Holzpartikelplatte 18 mm mit niedrigem Formaldehydgehalt, mit Polyurethanharzen lackiert

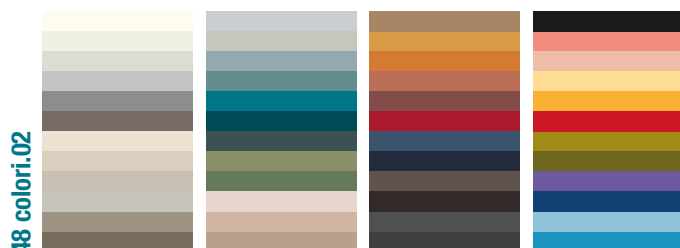



Maniglia PONTE - L 20 cm

FINITURE:

. laccato OPACO 48 colori.02
. extra pag. 592

PONTE Handle - L 20 cm

FINISHES:

. MATT lacquered 48 colori.02
. extra pag. 592

Poignée PONTE - L 20 cm

FINITIONS:

. laqué MAT 48 colori.02
. extra pag. 592

PONTE Griff - L 20 cm

OBERFLÄCHEN:

. MATT lackiert 48 colori.02
. extra pag. 592



CROMO OPACO



TITANIO



ORO OPACO SATINATO



Maniglia FILO - L 20 cm

FINITURE:

. laccato OPACO 48 colori.02

FILO Handle - L 20 cm

FINISHES:

. MATT lacquered 48 colori.02

Poignée FILO - L 20 cm

FINITIONS:

. laqué MAT 48 colori.02

FILO Griff - L 20 cm

OBERFLÄCHEN:

. MATT lackiert 48 colori.02

**abbinamento consigliato mobile/maniglia
combinations furniture/handle**



**coordinations meuble/poignée
Griffeabstimmung**

mobile Nobilitato LEGNO

-  12W ABETE BIANCO
-  14W ABETE BROWN
-  26W ABETE ROCCIA
-  27W ABETE FONDENTE
-  31W FRONDA PURO
-  32W FRONDA LIEVE
-  33W FRONDA NUDO
-  34W FRONDA ARCANO



maniglia laccato OPACO

-  01 NUDE
-  0H CURCUMA
-  05 WILD
-  0U MOCHA
-  01 NUDE
-  0G EARTH
-  03 NATURE
-  59 NERO

CERAMICA
CERAMIC

CÉRAMIQUE
KERAMIK

Filopiano lavabo integrato
Integrated plan washbasin
Vasque en plan intégrée
Integrierte Waschtischplatte

51,5



46,5



SX / DX



foro rubinetto incl.
tap hole incl.
trou pour le robinet incl.
Armaturbohrung inkl.

provisto di scarico troppopieno
with overflow system
avec système de trop-plein
mit Überlaufsystem

kit piletta e sifone da ordinare separatamente
waste kit and siphon to be ordered separately
kit bonde d'évacuation et siphon à commander séparément
Ablauf Kit und Siphon müssen separat bestellt werden

materiale inorganico non metallico composto da argilla, caolino, feldspato, quarzo, molto duttile allo stato naturale, rigido dopo la fase di cottura. Lo smalto bianco o colorato oltre allo scopo estetico rende impermeabile la massa ceramica

inorganic material composed of clay, kaolin, feldspar and quartz. In addition to the aesthetic purpose, the white or colored glaze makes the ceramic mass waterproof

matériau inorganique non métallique d'argile, de kaolin, de feldspath et quartz. En plus de sa fonction esthétique, le vernis blanc ou coloré rend la masse céramique imperméable

anorganisches nichtmetallisches Material, aus Ton, Kaolin, Feldspat und Quarz. Neben dem ästhetischen Zweck macht die weiße oder farbige Glasur die Keramikmasse wasserdicht

lavabo integrato
integrated washbasin
vasque intégrée
integriertes Becken

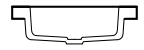

CERBIA

BIANCO LUCIDO

CERC02

POLVERE OPACO

CERC03

CRETA OPACO

CERC04

MALTA OPACO

CERC05

ANTRACITE OPACO

CERBIO

BIANCO OPACO

colore CERAMICA

cartella colori.02

 CERC02 POLVERE OPACO

 02 ROYAL

 CERC03 CRETA OPACO

 03 NATURE

 CERC04 MALTA OPACO

 0F ROMAN

 CERC05 ANTRACITE OPACO

 16 DEEP GREY

i colori qui riportati sono da considerarsi indicativi
the colours can diverge from the reality
la fidélité des couleurs peut être différent de la réalité
bitte berücksichtigen Sie unsere Farbfächer zur Farbauswahl

TOLLERANZA LARGHEZZA E PROFONDITÀ

Misura nominale	Tolleranza in larghezza	Tolleranza sulla P 51,5	Tolleranza sulla P 45
da 61 a 81 cm	+ 6 / - 5 mm	+ 4 / - 2mm	+ 5 / - 3 mm
91 cm	+ 7 / - 5 mm	+ 4 / - 2mm	+ 5 / - 3 mm
da 106 a 141 cm	+ 10 / - 6 mm	+ 4 / - 2mm	+ 6 / - 3 mm

TOLLERANZA DEFORMAZIONE DEI BORDI

Larghezza lavabo	Valore della tolleranza
< = 90 cm	max 3 mm
> 90 cm < 125 cm	max 4 mm
> = 125 cm	max 5 mm

TOLLERANZA PIEGATURA DEI BORDI

Larghezza lavabo	Valore della tolleranza
< = 90 cm	± 1,5 mm
> 90 cm < 125 cm	± 2,5 mm
> = 125 cm	± 4 mm

TOLLERANZA SPESSORE DEL LAVABO

< = 25 mm	max 3 mm
> 25 mm < 50 mm	max 4 mm

CASTMARBLE

Filopiano lavabo integrato
Integrated plan washbasin
Vasque en plan intégrée
Integrierte Waschtischplatte



foro rubinetto incl.
tap hole incl.
trou pour le robinet incl.
Armaturbohrung inkl.

provisto di scarico troppopieno
with overflow system
avec système de trop-plein
mit Überlaufsystem

kit piletta e sifone da ordinare separatamente
waste kit and siphon to be ordered separately
kit bonde d'évacuation et siphon à commander séparément
Ablauf Kit und Siphon müssen separat bestellt werden

materiale composito costituito da carbonato di calcio, magnesio e resina poliestere. La finitura superficiale e l'assenza di giunzioni lo rende resistente

special material composed of carbonates, magnesium and polyhedral resins. The surface finish and the absence of joints makes it resistant

matériau spécial composé de alumine et résine acrylique. La finition de surface et l'absence de joints le rendent résistant

Spezialwerkstoff aus Aluminiumoxid und Acrylharz. Die Oberflächenbeschaffenheit und das Fehlen von Gelenken macht es resistent

lavabo integrato
integrated washbasin
vasque intégrée
integriertes Becken

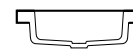

CASBIO

CASBIA

BIANCO OPACO

BIANCO LUCIDO

48 colori.02

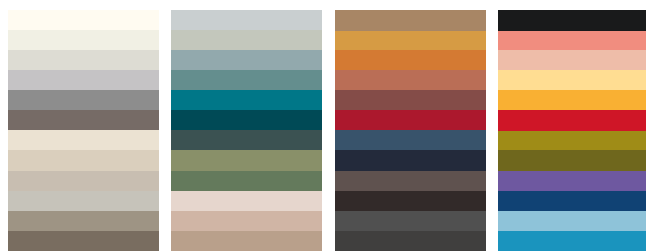

i colori qui riportati sono da considerarsi indicativi
the colours can diverge from the reality
la fidélité des couleurs peut être différent de la réalité
bitte berücksichtigen Sie unsere Farbfächer zur Farbauswahl

P 46,5 - H 1,5 cm

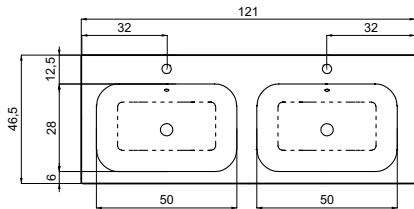
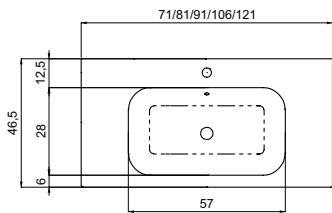
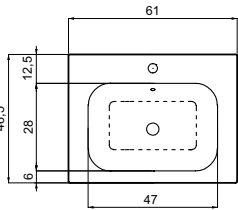
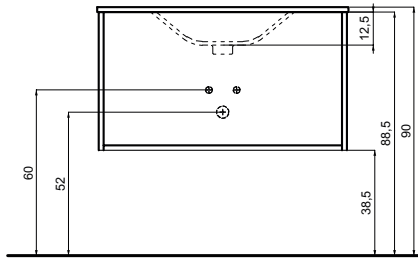

P 51,5 - H 1,5 cm

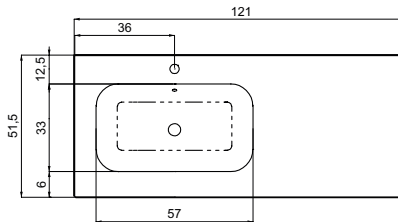
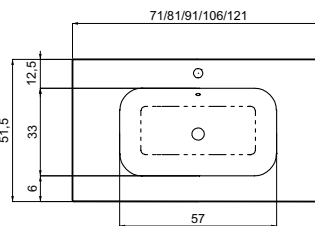
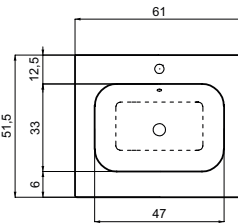
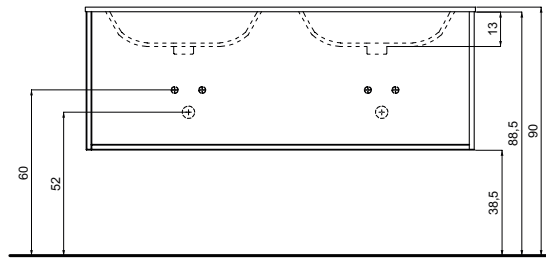

SX / DX

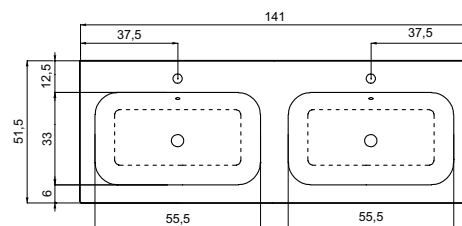
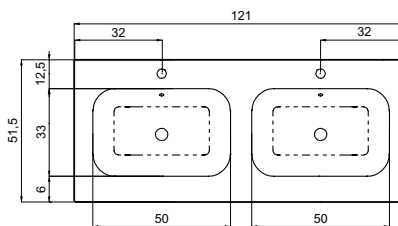

P 46 - H 1,2 cm

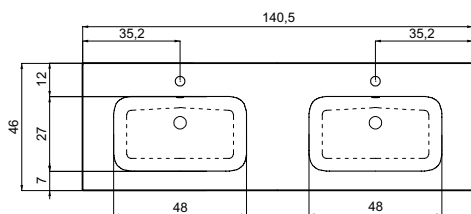
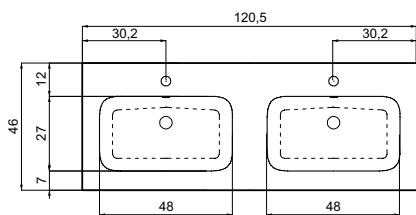
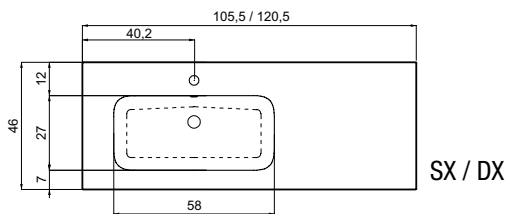
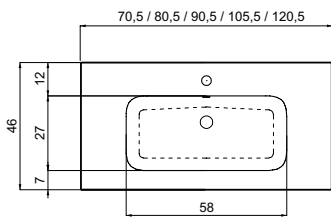
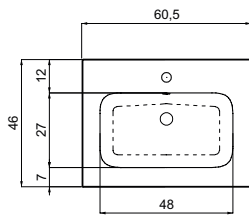
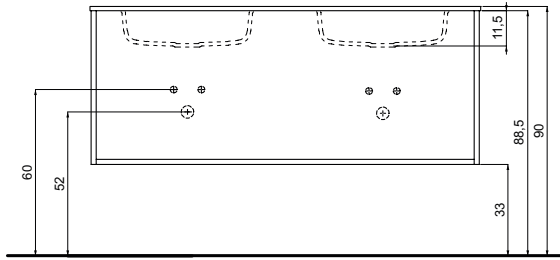

P 51,5 - H 1,2 cm

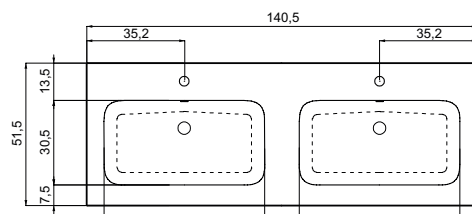
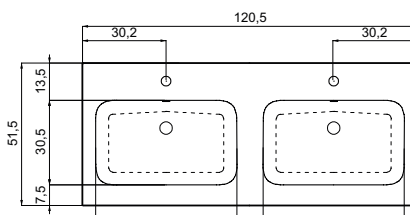
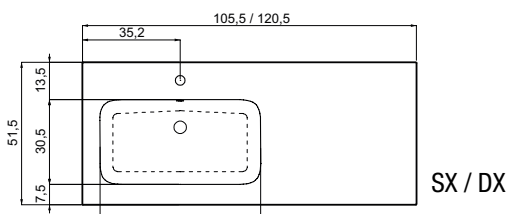
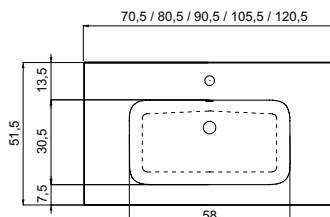
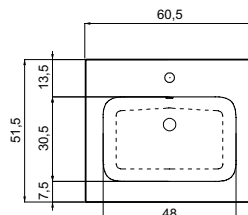
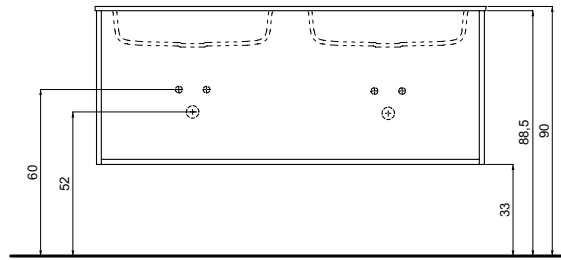

Modularità
Modularity

Modularité
Modularität

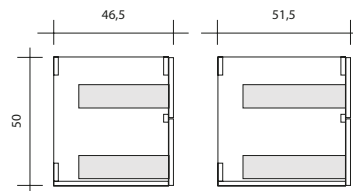
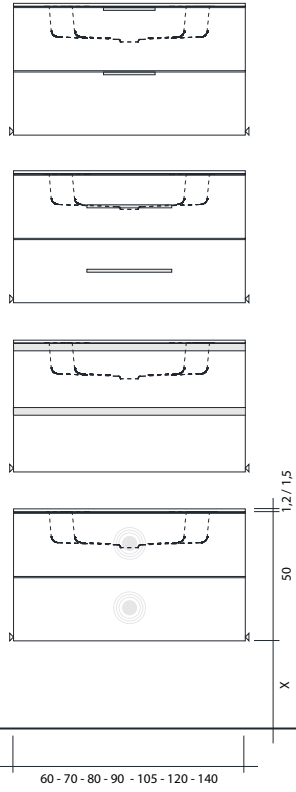

doppio frontale estraibile con cassetto, chiusura ammortizzata
double soft-closing pull-out
2 tiroirs amortis
2 Schubladen

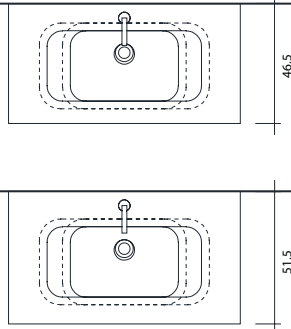

Parte tecnica
Technical section

P 46,5 - P 51,5 cm

Section technique
Technischer Teil

